

Parts Price List

DC-501 Double Check Valve Backflow Preventer 1/2", 3/4", 1"

2017

Parts Number	Description	No. refer to drawing	Price
0465-0501	Cover Assembly	1	\$45.00
0266-3101	Retainer	3	\$9.00
0465-0276-IN	Inlet Check Valve Assembly	2	\$30.00
0466-0276-OUT	Outlet Check Valve Assembly	4	\$30.00
0310-7318BPM-14NTFBA	Test Cock 1/8" BSP	10	\$15.00
0466-4801NT	Adaptor Assembly NPT 1"	6, 9	\$19.50
0466-4850NT	Adaptor Assembly NPT 1/2"	6, 9	\$19.50
0466-4834NT	Adaptor Assembly NPT 3/4"	6, 9	\$19.50
0466-99	Clamp Assembly	7	\$10.50
0465-5699-01-CRK	Complete Rubber Repair Kit		\$17.00



DC-501

DC-501 Double Check Valve Backflow Preventer 1/2", 3/4", 1"

Parts Exploded View

No. Part Description

1. Cover Assembly
2. Inlet Check Valve Assembly #1
3. Retainer
4. Outlet Check Valve Assembly #2
5. Cover Seal
6. Inlet Shut-Off Valve
7. Clamp Assembly
8. Body Assembly
9. Outlet Shut-Off Valve
10. Test Cocks

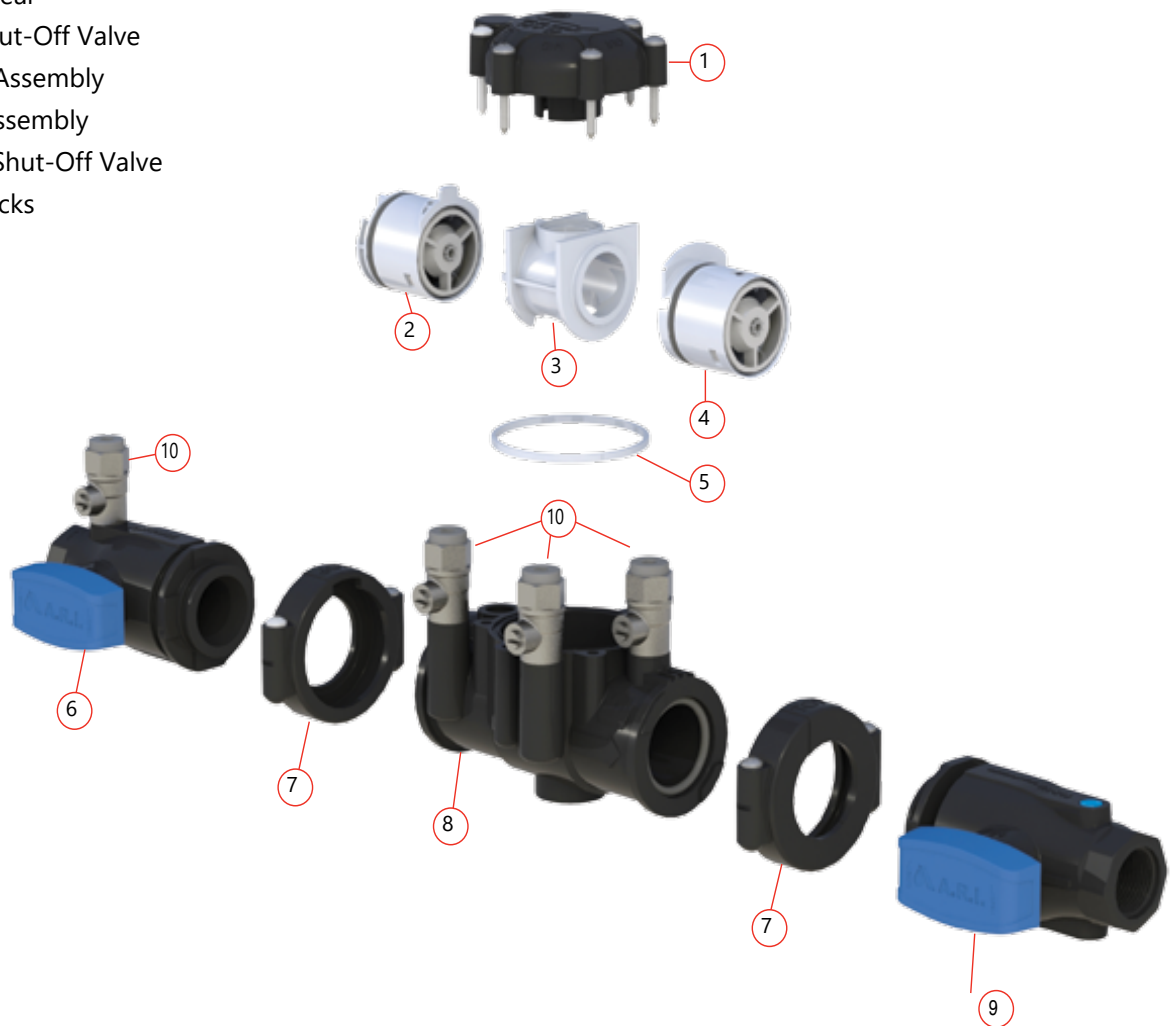

A.R.I. FLOW CONTROL ACCESSORIES Ltd.
www.arivalves.com avner@ari.co.il Tel: 858-2328279



USA Distributor Tel: (954) 980-9850 Email: cjhart@ubsbackflow.com

LIST DC-501